



INSTALLATION

★ ★ ★ INSTRUCTION ★ ★ ★

YZONA BRAND ADHERES TO THE PRINCIPLE OF QUALITY FIRST, WITH ALL PRODUCTS UNDERGOING RIGOROUS QUALITY TESTING TO ENSURE COMPLIANCE WITH INTERNATIONAL STANDARDS. WE HAVE ESTABLISHED LONG-TERM PARTNERSHIPS WITH SEVERAL RENOWNED AUTOMOTIVE MANUFACTURERS AND CONTINUOUSLY LAUNCH INNOVATIVE PRODUCTS THAT MEET MARKET DEMANDS, THANKS TO OUR STRONG R&D TEAM. OUR

GOAL IS TO ENHANCE VEHICLE PERFORMANCE AND SAFETY, ALLOWING EVERY DRIVER TO ENJOY THE PLEASURE OF DRIVING.



COMPATIBLE WITH:

2005-2015 TOYOTA TACOMA

PARTS LIST:

IF ACCESSORIES ARE MISSING, PLEASE CONTACT CUSTOMER SERVICE.



MAIN BODY X1



D-RINGS RIGHT X1



D-RINGS LEFT X1



FLAT WASHER X12



HEX HEAD NUT X6



SPRING WASHER X6



HEX HEAD BOLT X6

TOOLS NEEDED:

STRONGLY RECOMMEND PROFESSIONAL AUTO PARTS INSTALLATION.

- 8-15mm Socket
 - 15-20mm Socket
- Plastic remover tool or similar



ASSEMBLY PRODUCT

STEP 01:

BEFORE INSTALLATION, MAKE SURE YOU HAVE THE NECESSARY TOOLS READY. GOOD TOOLS CAN MAKE THE JOB TWICE AS EFFICIENT.



- After removing the product, we obtained the main part A1 and two tow hooks, A2 and A3.

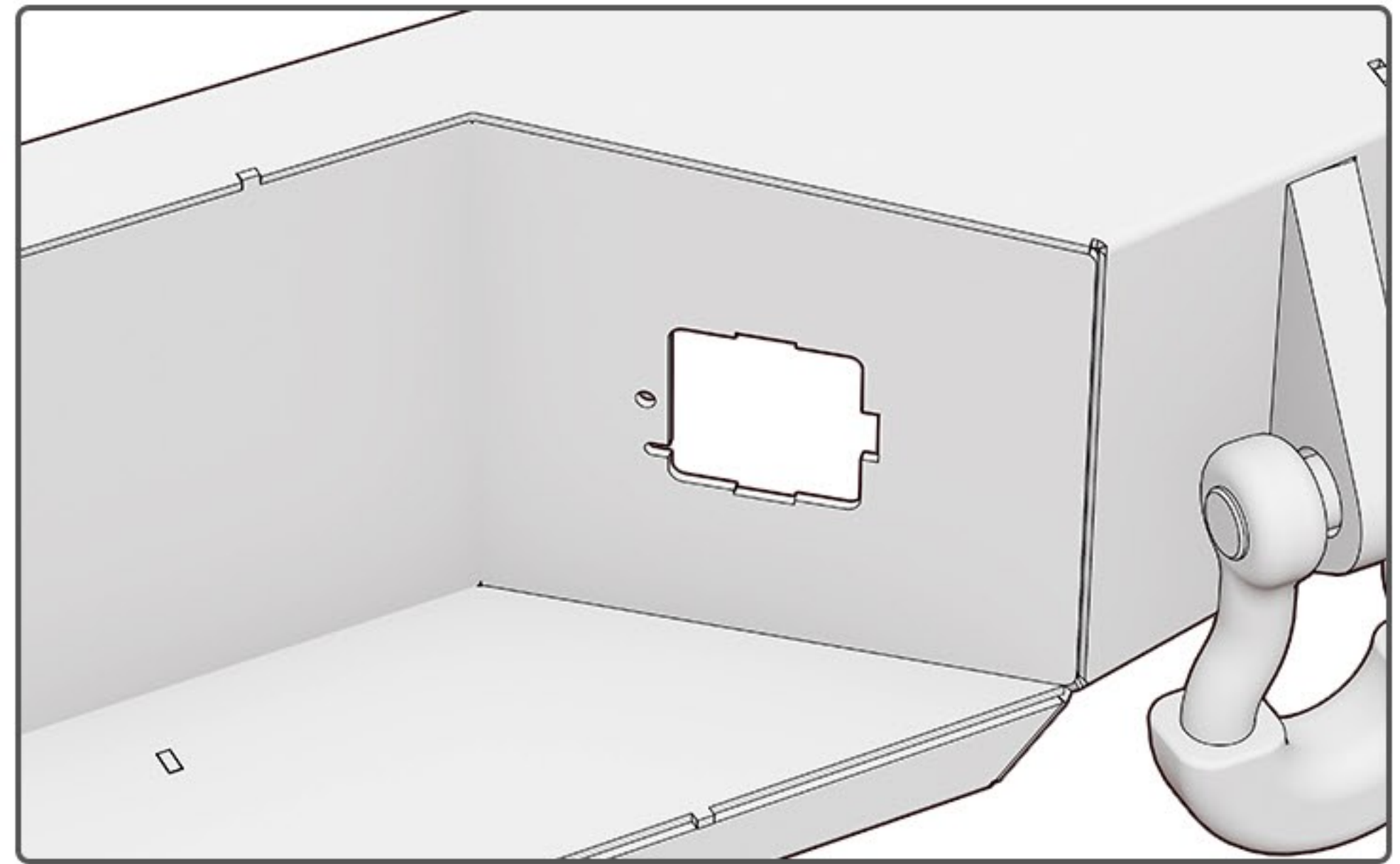
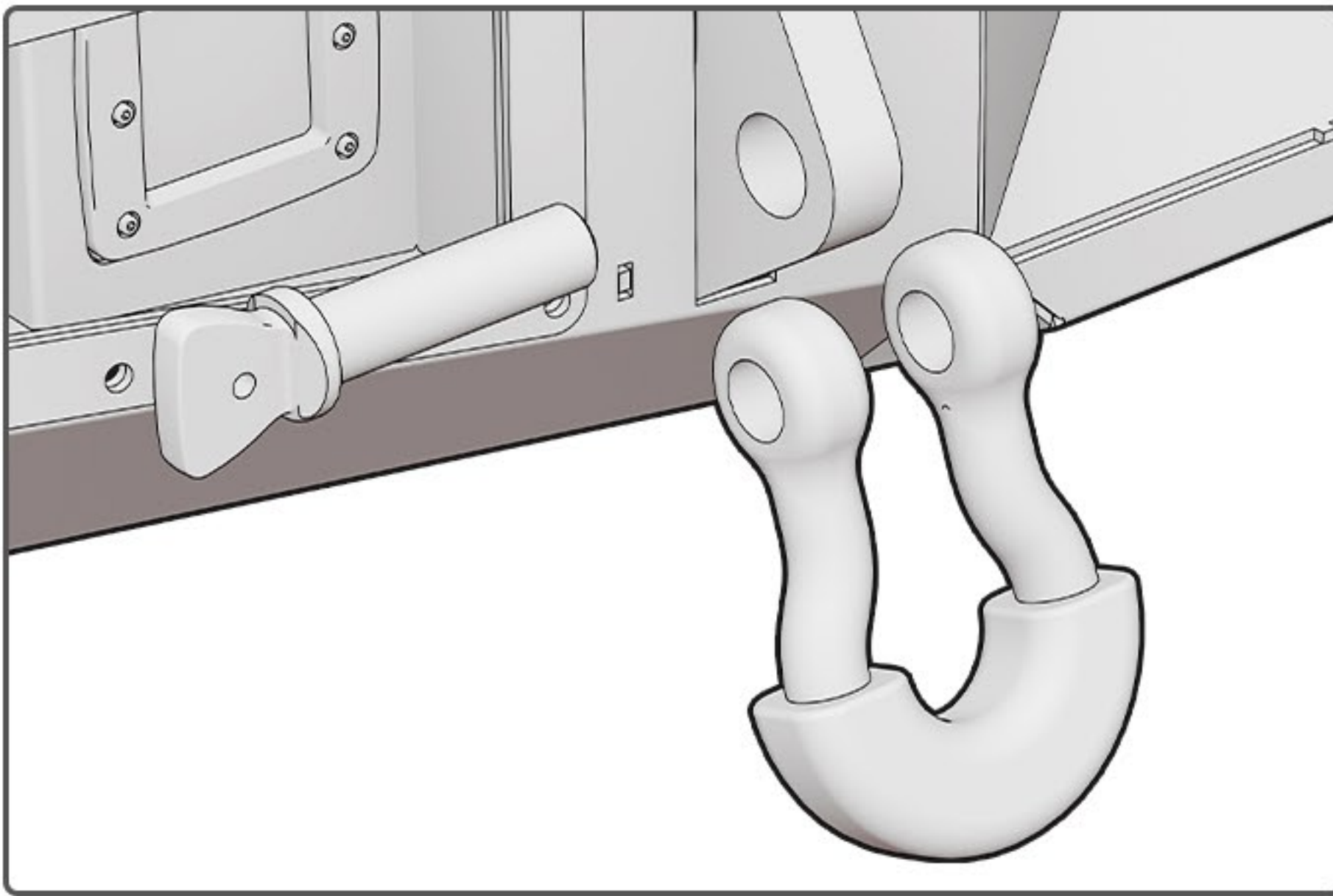

- Install A2 and A3 onto the main part and tighten them securely.
- We have provided installation holes for the license plate light. After removing the license plate light, assemble it onto the new bumper.

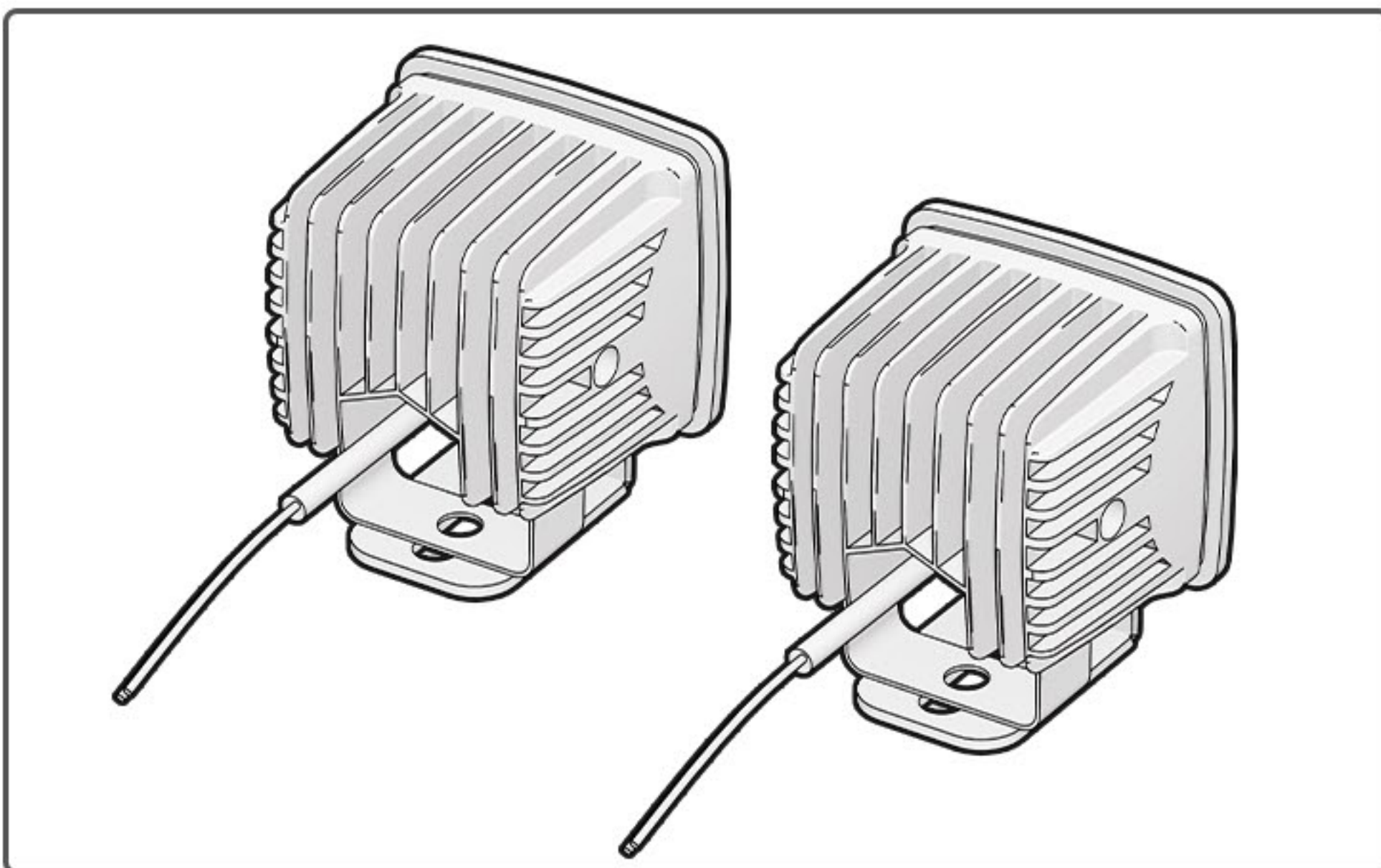

- We have provided 4 LED lights, each rated at 18W, and you will need to purchase a wiring harness separately for installation.
- We strongly recommend professional installation. We will not be liable for any product damage caused by improper handling or installation.

HOW TO REMOVE THE REAR BUMPER

STEP 02:

INSTALLING THE BUMPER REQUIRES A PRY BAR OR FLATHEAD SCREWDRIVER, AS WELL AS AN APPROPRIATE RATCHET WRENCH.

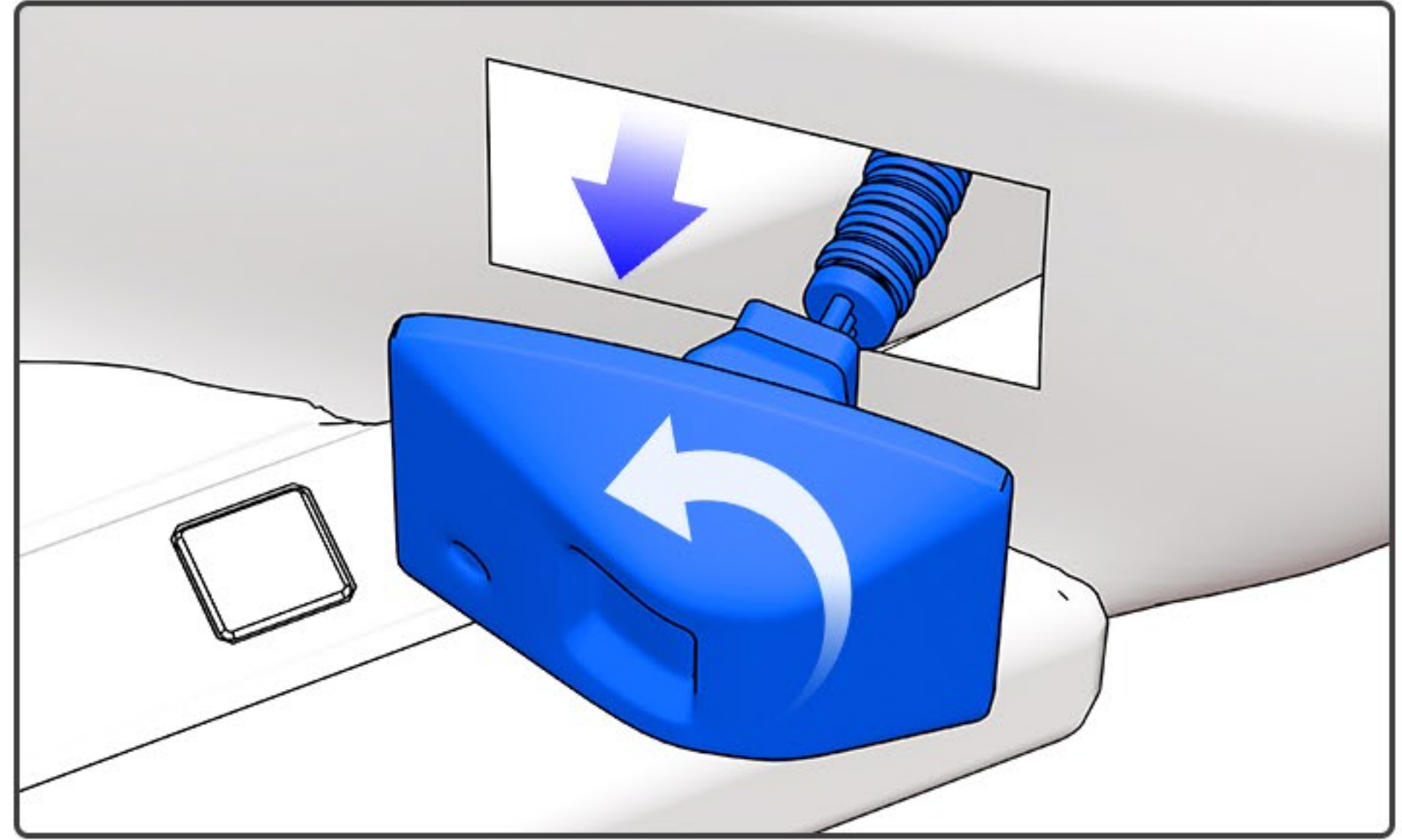
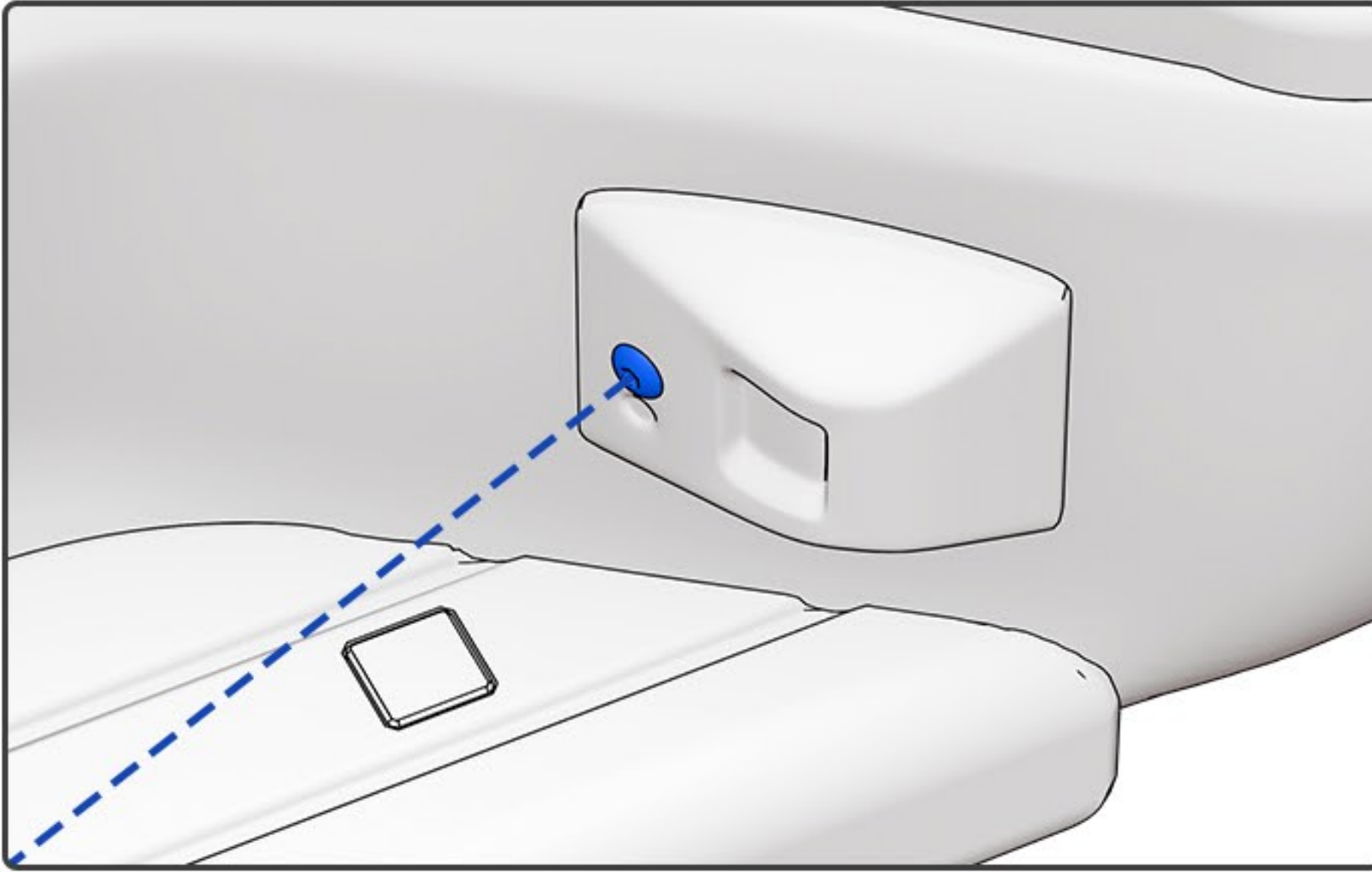

- Locate and remove the screws on the license plate light. Rotate counterclockwise to remove the cover, then set aside the bulb for future use.

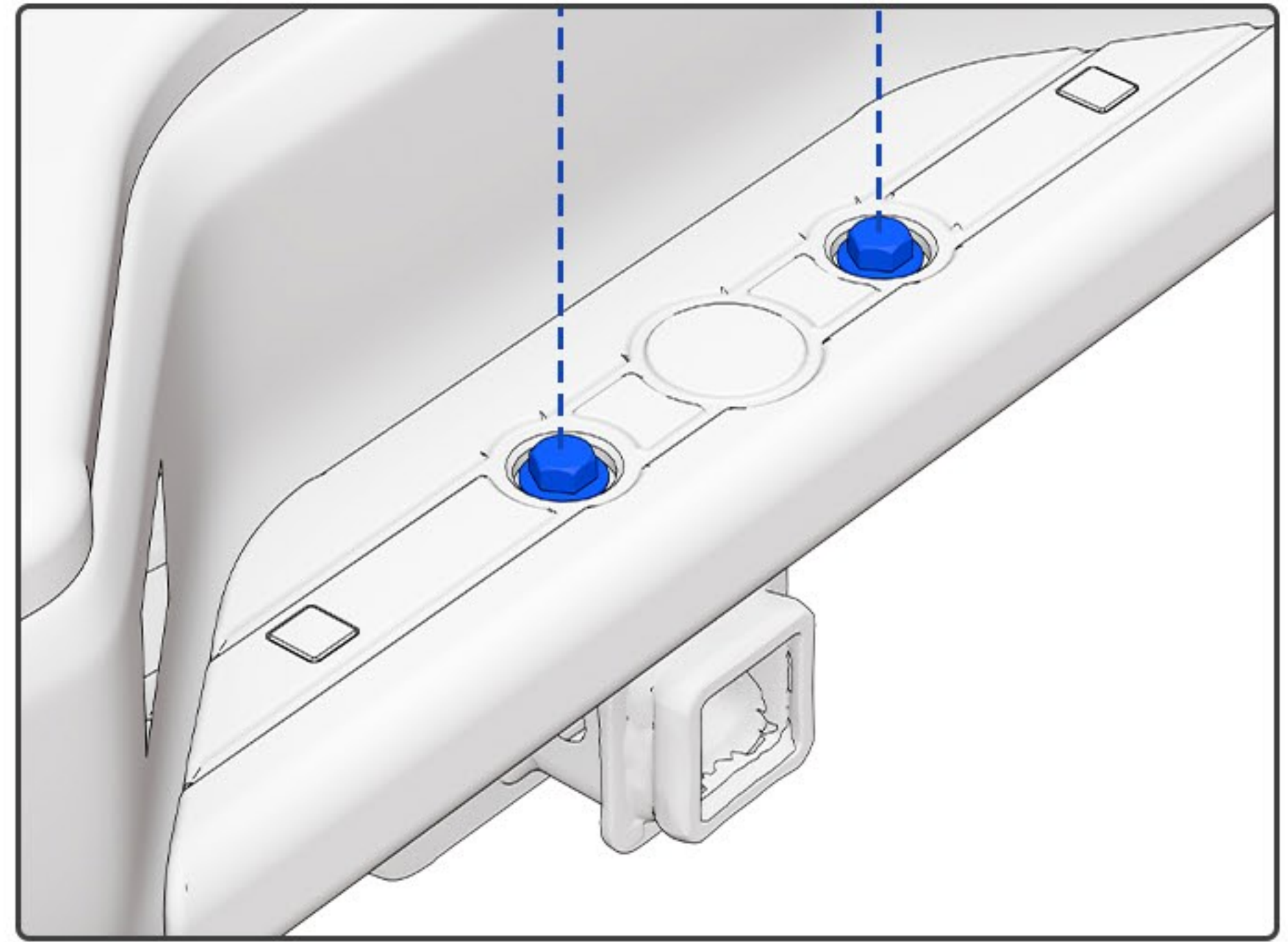
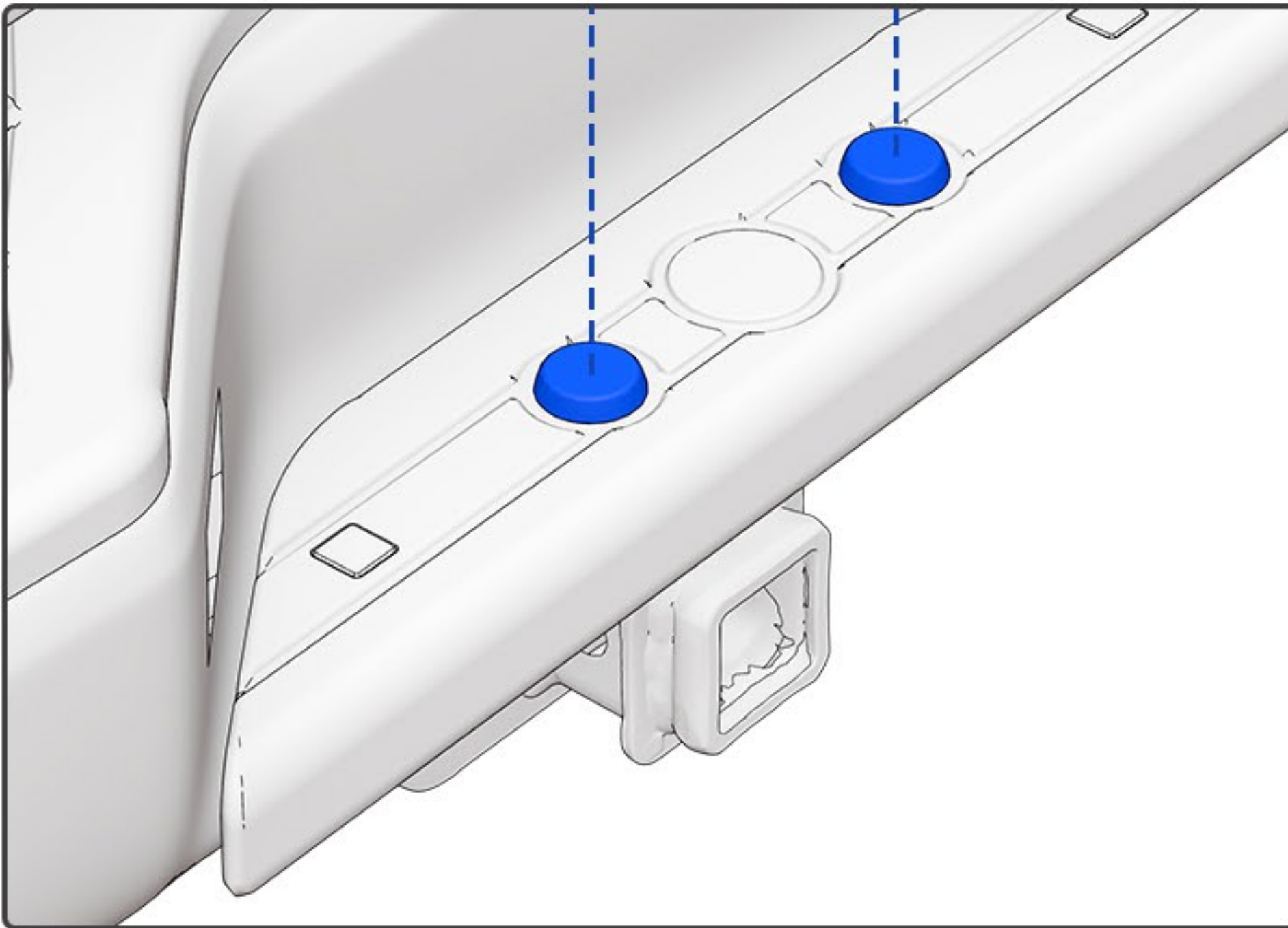

- Next, use a pry bar to remove the two plastic covers on the bumper step plate, then remove the two fixing screws inside.

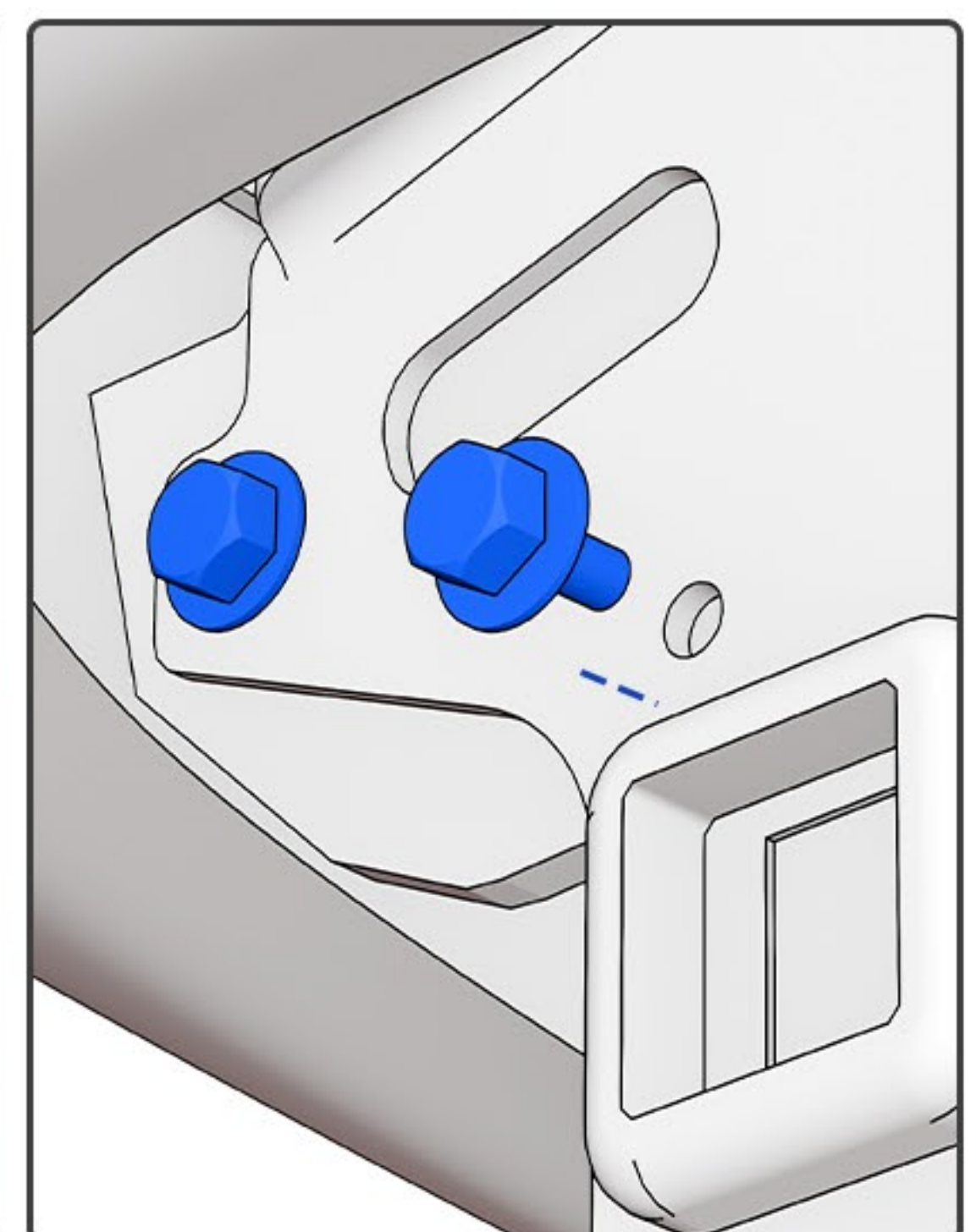
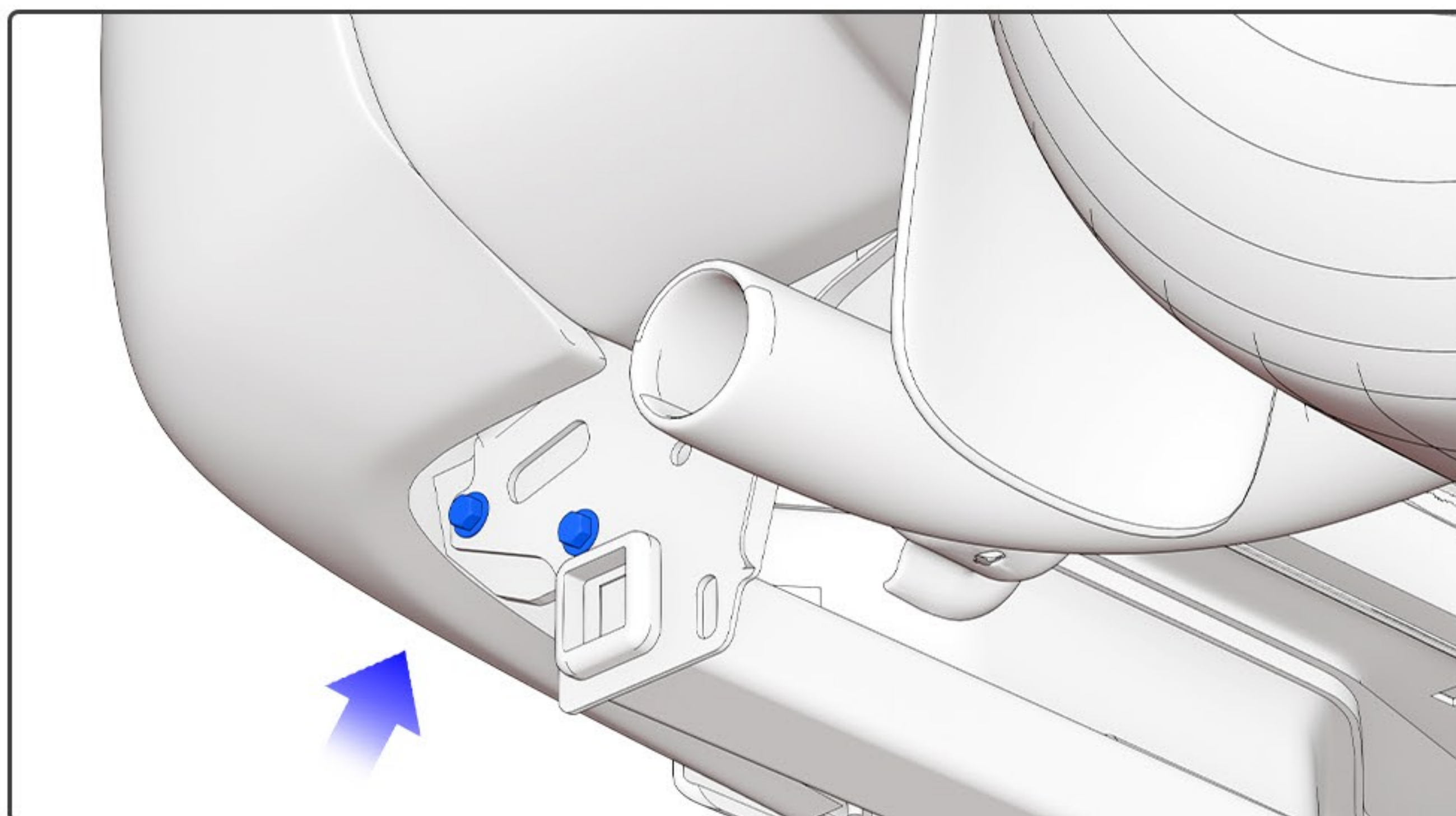

- Near the rear impact beam, you will see two bumper fixing screws. Use a ratchet wrench to remove them. Repeat the same process on the other side.

HOW TO REMOVE THE REAR BUMPER

STEP 03:

REMOVING THE BUMPER REQUIRES A POWER RATCHET WRENCH, WHICH WILL HELP YOU REMOVE THE SCREWS MORE EASILY.

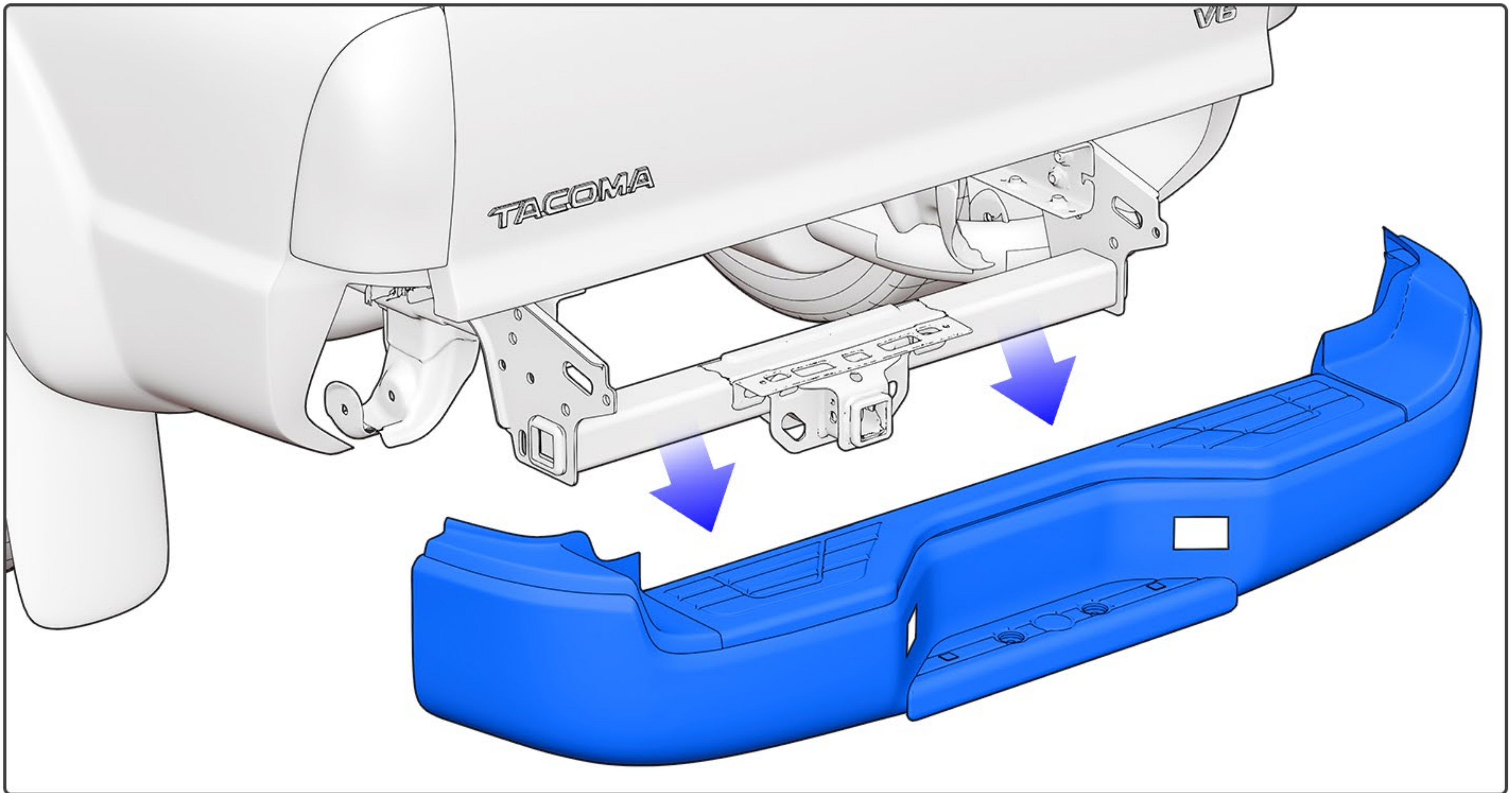

- Next, with the help of a friend, carefully remove the rear bumper. Pay attention to the position of the wiring harness to avoid pulling it out or damaging it.

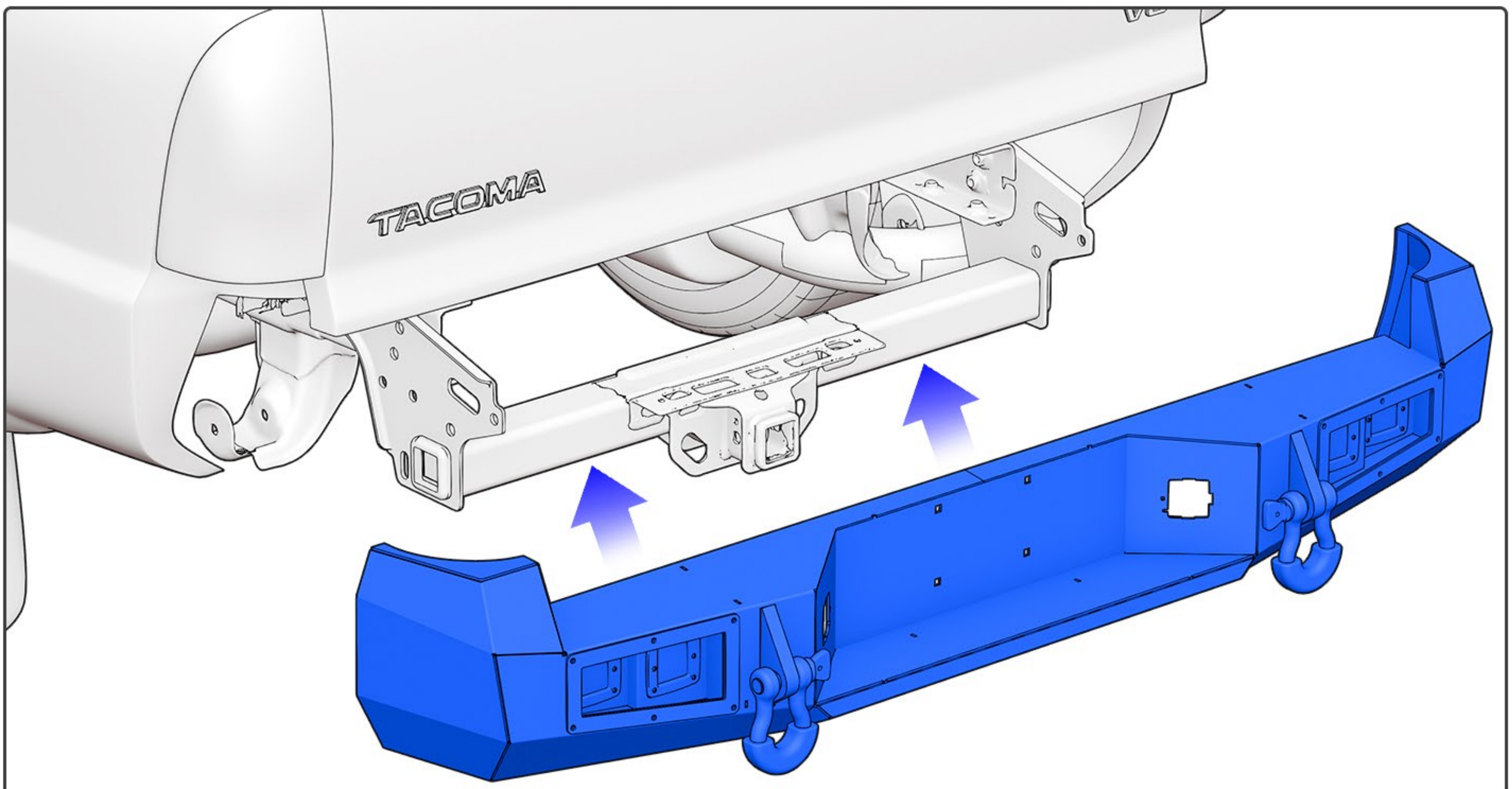

- Take the assembled bumper and, with the help of a friend, lift it into place on the car. One person should lift the bumper, while the other ensures it is at the correct height and uses a ratchet wrench to secure the screws.
- Before installing the bumper, you need to connect the wiring harness. We apologize, but the wiring harness is not provided and must be purchased separately by the customer.

INSTALL THE PRODUCT ONTO THE VEHICLE

STEP 03:

TO MAKE INSTALLATION EASIER, THE LICENSE PLATE FRAME LIGHT CAN BE PLACED ON THE BUMPER IN ADVANCE.

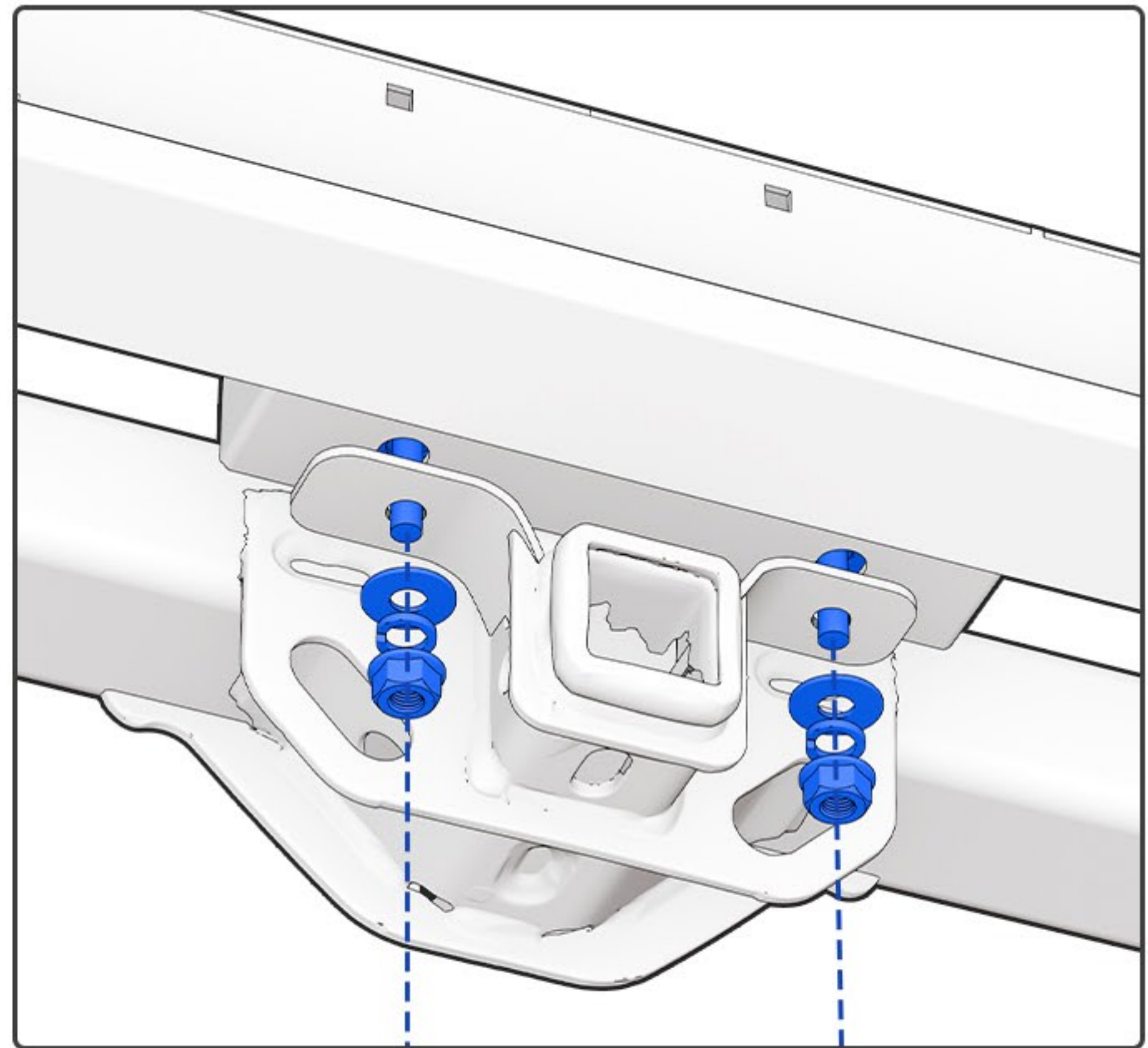
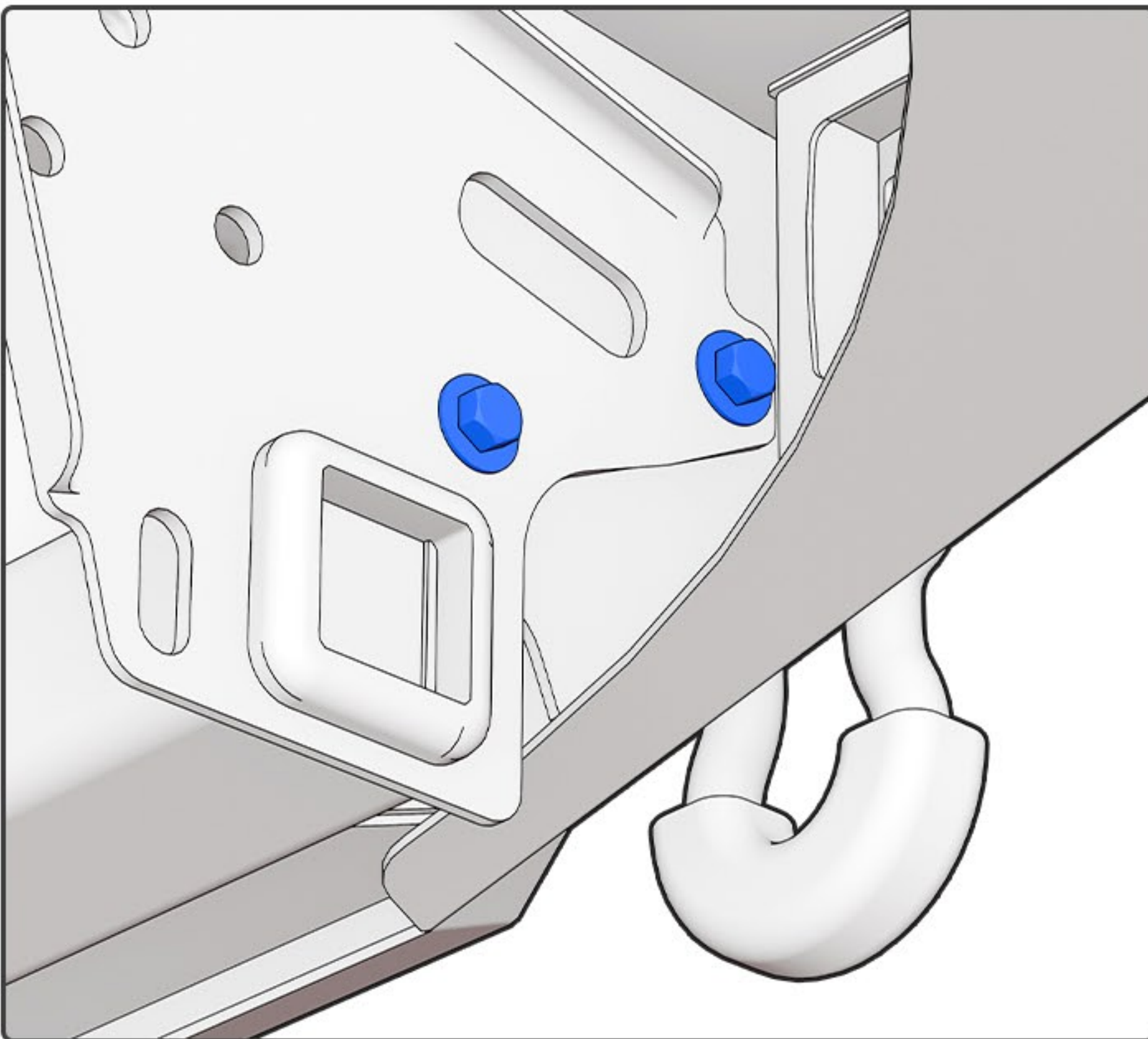

- Next, use two M12 screws to secure the bumper. Use a ratchet wrench to tighten the screws to prevent them from coming loose.
- Locate the holes at the bottom of the tow hook, then use a ratchet wrench to secure two M12 screws. You can also use the factory screws for fixing.

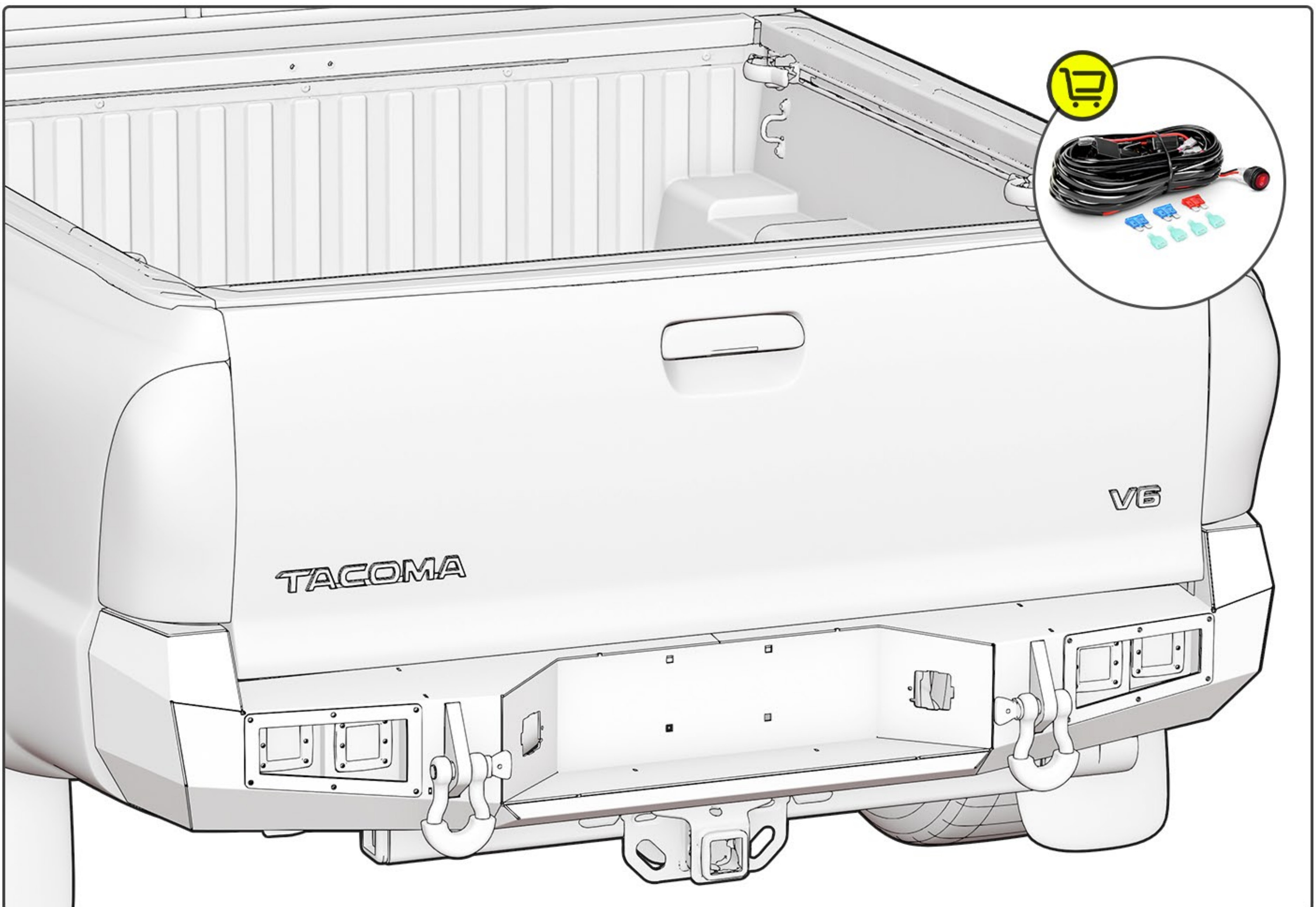

- After installing the bumper, the next step is to reinstall the original license plate light. The installation steps are the reverse of the removal process.

ELECTRICAL INSTALLATION

- This bumper is equipped with LED lights that need to be connected to a power source. Failing to make these connections correctly may cause damage to the LED lights and/or your vehicle, and could potentially result in personal injury.
- If you are not qualified to make these connections properly, we strongly recommend contacting a professional installer to complete the connections.

NOTICE

- The images in the manual are for reference only and may differ from the actual product, but the installation process is the same.
- Please regularly check all components connected to the vehicle for looseness to ensure safe use.



YZONA to find your parts



yzona.autoparts



Yzona Autoparts



YZONA-Auto-Parts



yzona.autoparts

a.autoparts

yzona.auto

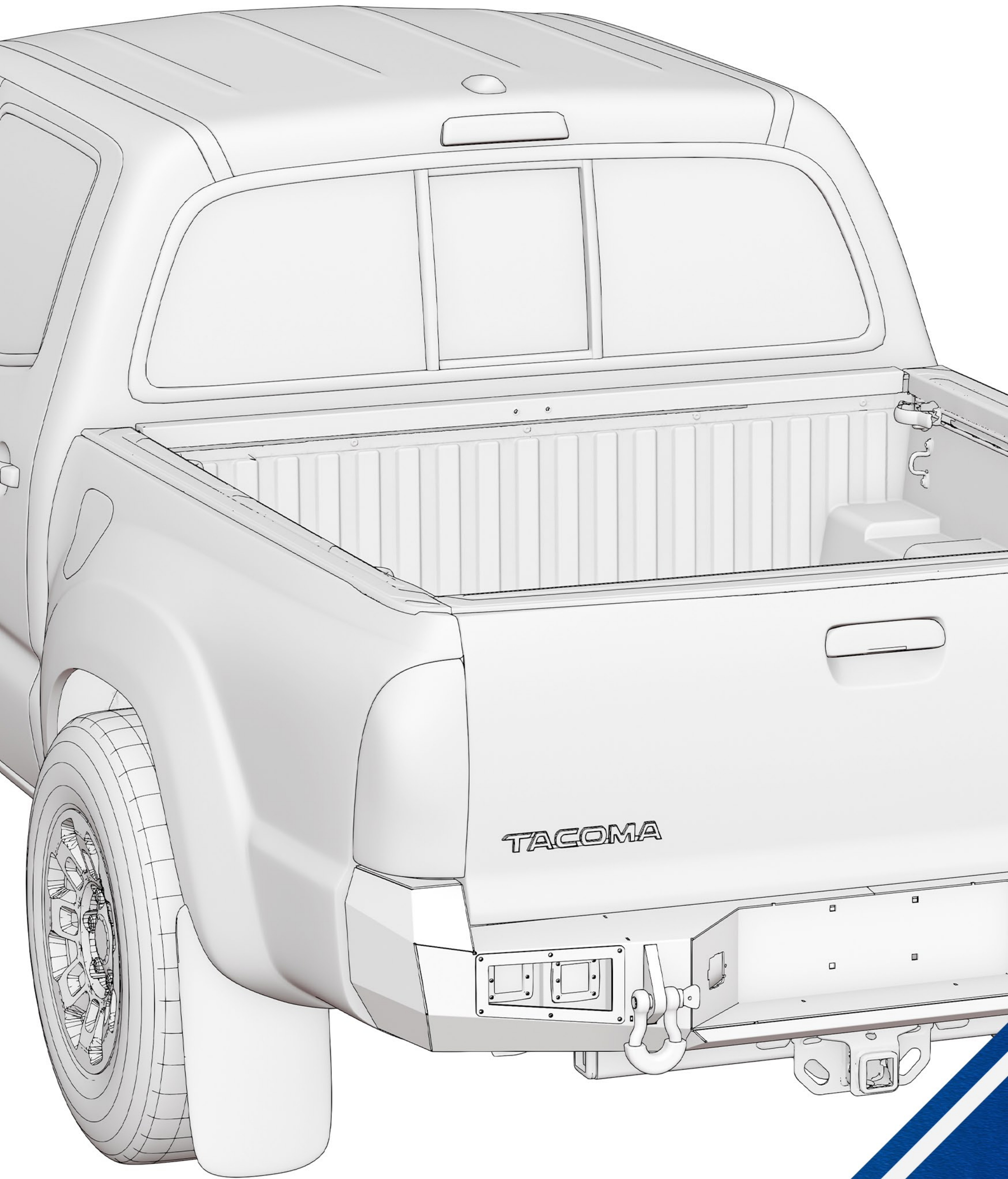

THANK YOU FOR CHOOSING US.

If there are any missing or damaged items,
please contact us as soon as possible.